

LOT GRADING PLAN
of all of
LOT 58 REGISTERED PLAN No.
33M-746, EDGEWATER ESTATES
Mun. No. 138 Edgewater Boulevard
in the
MUNICIPALITY OF MIDDLESEX CENTRE
COUNTY OF MIDDLESEX
Scale 1 : 250

AREA OF LOT = 811.51 Sq.m.
AREA OF DWELLING = 298.24 Sq.m. (36.75%)
LANDSCAPED OPEN SPACE = 513.27 Sq.m. (63.25%)

	<p>P.O. Box 8079, 1225 Wonderland Rd. N. London, Ontario Tel. 680-1605 Fax. 680-2403</p>	<p>I hereby certify that the proposed grading and appurtenant drainage works comply with sound engineering design and that the proposed grading is in general conformity for drainage and relative elevations with the Accepted Subdivision Grading Plans filed with the City Engineer or attached to the subdivision agreement.</p>	
SCALE: 1 : 250			
NOV. 25/19			
DRAWN BY: D. STEWART			

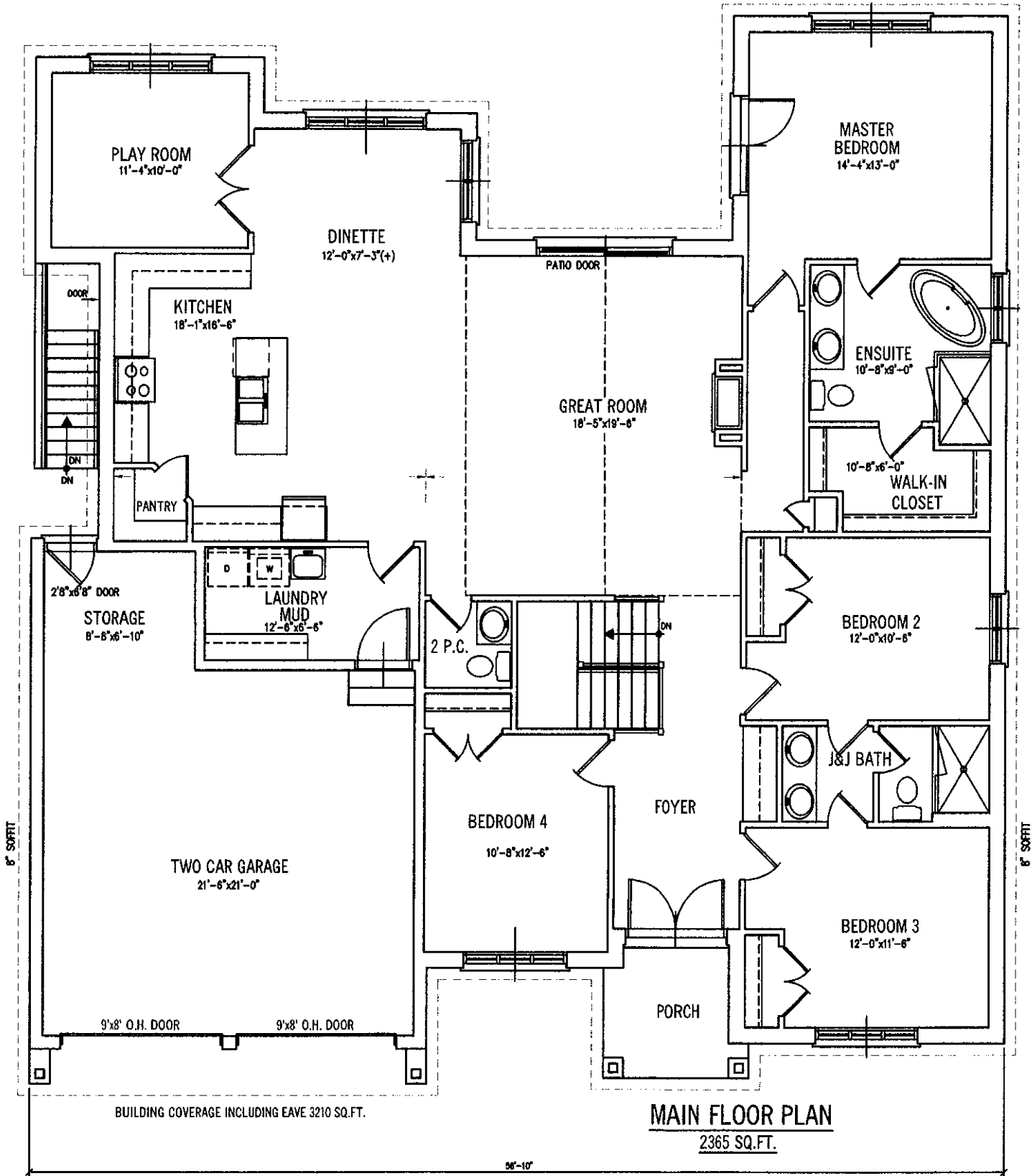

BUILDING COVERAGE INCLUDING EAVE 3210 SQ.FT.

MAIN FLOOR PLAN

2365 SQ.FT.

56'-10"